

Diesel fuel tank

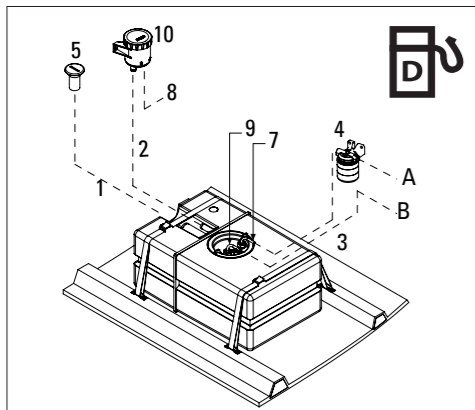

Install the tank in a well-ventilated space on board. Only use fuel resisting hoses and avoid sharp bends and kinks. Make sure that the hoses are not resting on sharp edges, so as to avoid chafing. The $\varnothing 38$ mm fuel filling hose must be connected to the corresponding stub on the tank. The suction line (A) and the return line (B) are to be connected to the corresponding connectors on top of the inspection cover.

Run the breather line in such a way that it is continuously sloping up towards the breather nipple. Secure all hose connections with a properly fitting hose clamp.

Position the breather nipple in such a manner that neither seawater nor rain can enter, and where diesel fuel or diesel fumes can't enter the boat, when topping up the tank or when the boat is heeling over. Secure all hose connections by means of a properly fitting hose clamp.

Owing to the insulating properties of this LLDPE-made tank, the formation of condensation water will hardly ever occur. If the boat is not used during a prolonged period of time, fill the fuel tank to the brim, so as to avoid condensation and bacterial growth.

Additional components, not belonging to the standard scope of supply

1. Fuel filling hose $\varnothing 38$ mm (**GA.020.20038**)
2. Fuel hose $\varnothing 19$ mm (**GA.030.20019**)
3. Fuel hose $\varnothing 8$ mm (**GA.030.20008**)
4. Water separator (**AH.010.20008**)
5. Deck entry (**CC.010.20000**)
6. Stainless steel hose clamps (**GC.010.2.xxxx**)
7. Connection kit "Fuel" (**CB.010.20030/ CB.010.20035**)
8. Breather nipple (**CD.010.21019**)
9. Fuel level sensor (**CB.020.20020**)
10. No-smell filter (**CF.020.20019**)

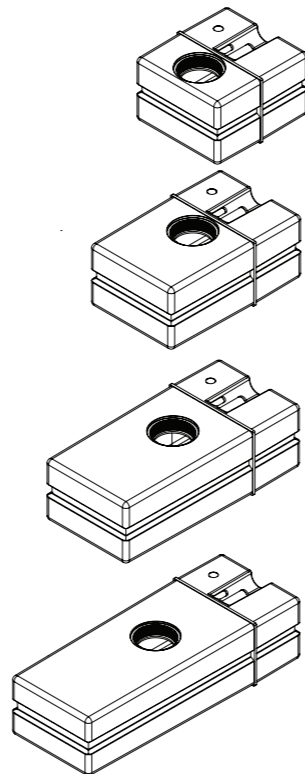

AG-010-007.1.2.01.10

Main dimensions

CA.010 - 20033

Net volume:	33 liter
Filling line:	$\varnothing 38$
Breather line:	$\varnothing 19$
Empty weight:	4.1 Kg
Dimensions in mm LxBxH (without kit):	420x380x250
Max. pressure:	0,2 bar

CA.010 - 20050

Net volume:	50 liter
Filling line:	$\varnothing 38$
Breather line:	$\varnothing 19$
Empty weight:	6.5 Kg
Dimensions in mm LxBxH (without kit):	600x380x250
Max. pressure:	0,2 bar

CA.010 - 20065

Netto volume:	65 liter
Filling line:	$\varnothing 38$
Breather line:	$\varnothing 19$
Empty weight:	7.3 Kg
Dimensions in mm LxBxH (without kit):	800x380x250
Max. pressure:	0,2 bar

CA.010 - 20080

Netto volume:	80 liter
Filling line:	$\varnothing 38$
Breather line:	$\varnothing 19$
Empty weight:	7.8 Kg
Dimensions in mm LxBxH (without kit):	1000x380x250
Max. pressure:	0,2 bar

ATTENTION! Dimensions without connection kit

Printed in the Netherlands

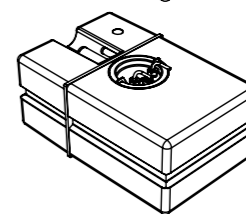
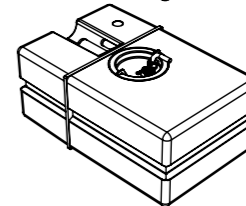
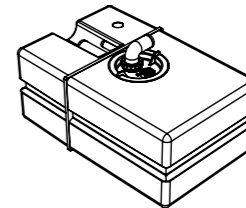

TANKS
MANUAL

CA.010 - 20033 CA.010 - 20065
CA.010 - 20050 CA.010 - 20080



Craftsman
MARINE

Installation

Introduction

All Craftsman Marine tanks are universally applicable, for storage of both diesel fuel and drinking water or waste water. By means of installation of the relevant connection kit onto the tank, the reservoir will get the right connections for its intended use. (connection kit to be ordered separately)

The connection kit also contains fastening materials for the tank in question. The scope of supply does not include any hoses or hose clamps. At all times a level sensor can be installed as a retro-fit, without the need to dismantle the tank or disconnect the hoses.

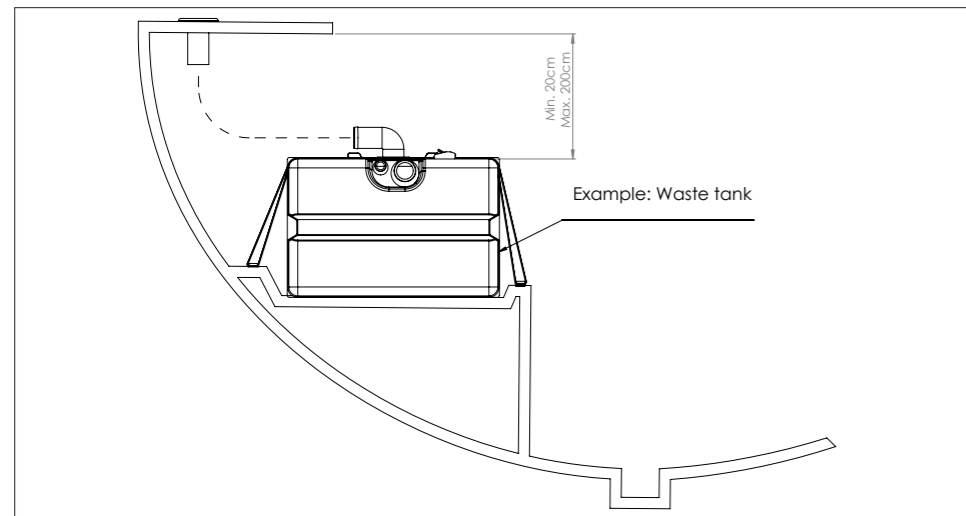

Installation

Fit the tank on a solid, horizontal base, making good use of the supplied brackets and straps. Make sure to leave sufficient room above the tank to connect the filling/suction hose to the deck entry,

as well as for inspection of the tank through the cover. The filler hose must be continuously sloping down from the deck entry and should be kept as short as possible

Water tank

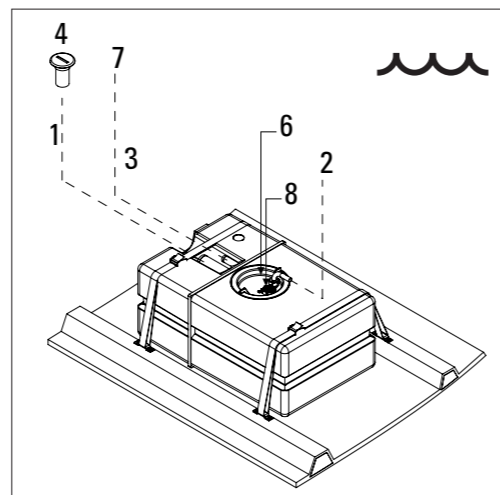

Always use reinforced, tasteless and non-toxic, food quality water hoses and avoid sharp bends or kinks. Secure all hose connections by using a properly fitting stainless steel hose clamp.

Position the breather line in such a way that it is continuously sloping up towards the breather nipple. Position the nipple in such a way that neither rain nor sea water can enter, nor drinking water, can enter the boat when filling in or when the boat heels over. The suction line (2) must be connected to a self-priming pump.

The Craftsman Marine water tanks, all being made of LLDPE, are absolutely corrosion-free, reduce the risk of algae and can be cleaned easily. Before taking the system into operation, the assembly should be rinsed with a water and soda solution. Before using the system for the first time, it may be disinfected by means of a bleach and water solution (1:1000). Pump this mixture through the entire system and rinse thereafter with clean tap water. At the beginning of each new sailing season, the system should be disinfected again.

Before winter storage, drain tank, pump and hoses from water.

Never ever introduce anti-freeze in the drinking water system!

Additional components, not belonging to the standard scope of supply:

1. Water filling hose Ø38 (GA.050.20038)
2. Water hose Ø12 (GA.050.20012)
3. Water hose Ø19 (GA.050.20019)
4. Deck entry (CC.010.20001)
5. Stainless steel hose clamps (GC.010.2.xxxx)
6. Connection kit "water" (CB.010.20020)
7. Breather nipple (CD.010.21019)
8. Water level sensor (CB.0x0.200xx)

Waste water tank

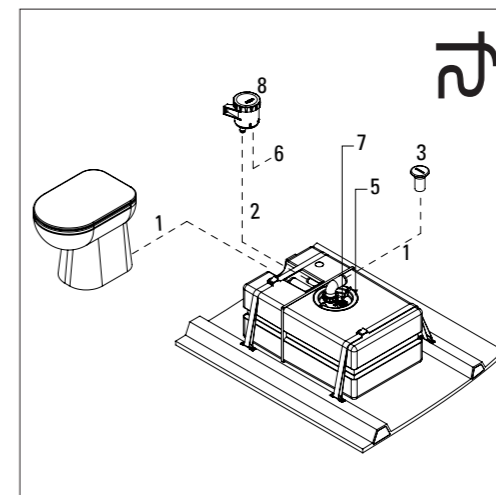

Always use reinforced and odour-tight waste water hoses. Avoid sharp bends or kinks. Connect the toilet to the ø38mm hose connector to the side of the tank. Connect the discharge hose to the ø 38 mm connector onto the tank cover.

Secure all hose connections by using a properly fitting stainless steel hose clamp. Position the breather line in such a way that it is continuously sloping up towards the breather nipple. Position the nipple in such a way that neither rain nor sea water can enter. It is recommended to fit a no-smell filter into the breather line. Avoid loosely dangling hoses and support them at regular intervals.

This Craftsman Marine tank, being made of LLDPE, is absolutely odour-tight and can be cleaned easily. In order to avoid clogging up and unwanted odours, the tank must be emptied on a regular basis. This can be done by means of a pump-out system ashore, to be connected to the deck entry, which is available in several yacht harbours. Do not put sanitary napkins etc. into the toilet, as this will greatly enhance the risk of clogging! The tank may be cleaned by using clean water and a toilet cleaning agent. In order to remove caustic scale from the tank, cleaning vinegar may be used. Thereafter, rinse with clean tap water.

Prior to winter storage, drain the tank, the pump and all hoses.

Never use anti-freeze in the waste water system during the winter period!

Additional components, not belonging to the standard scope of supply.

1. Odour-tight waste water hose Ø38mm (GA.040.20038)
2. Odour-tight waste water hose Ø19mm (GA.040.20019)
3. Deck entry (CC.010.20002)
4. Stainless steel hose clamps (GC.010.2.xxxx)
5. Connection kit "Waste Water" (CB.010.20010)
6. Breather nipple (CD.010.21019)
7. Waste water level sensor (CB.010.200xx)
8. No-smell filter