

Wall Thickness Min-3mm to Max-30mm

Cutout - $\phi 202$

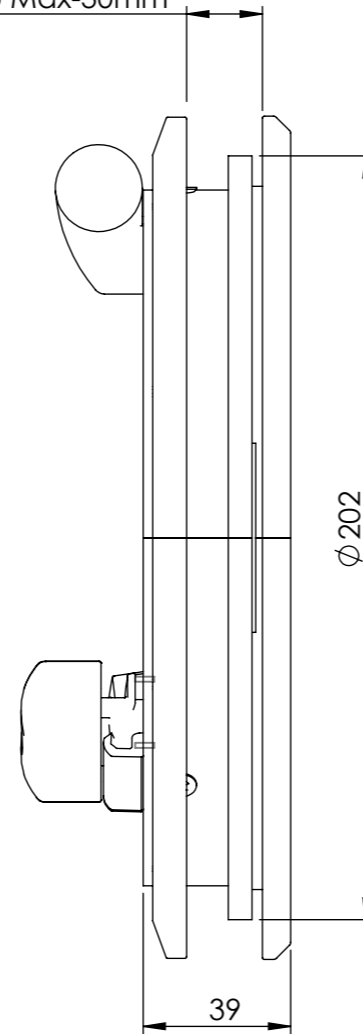
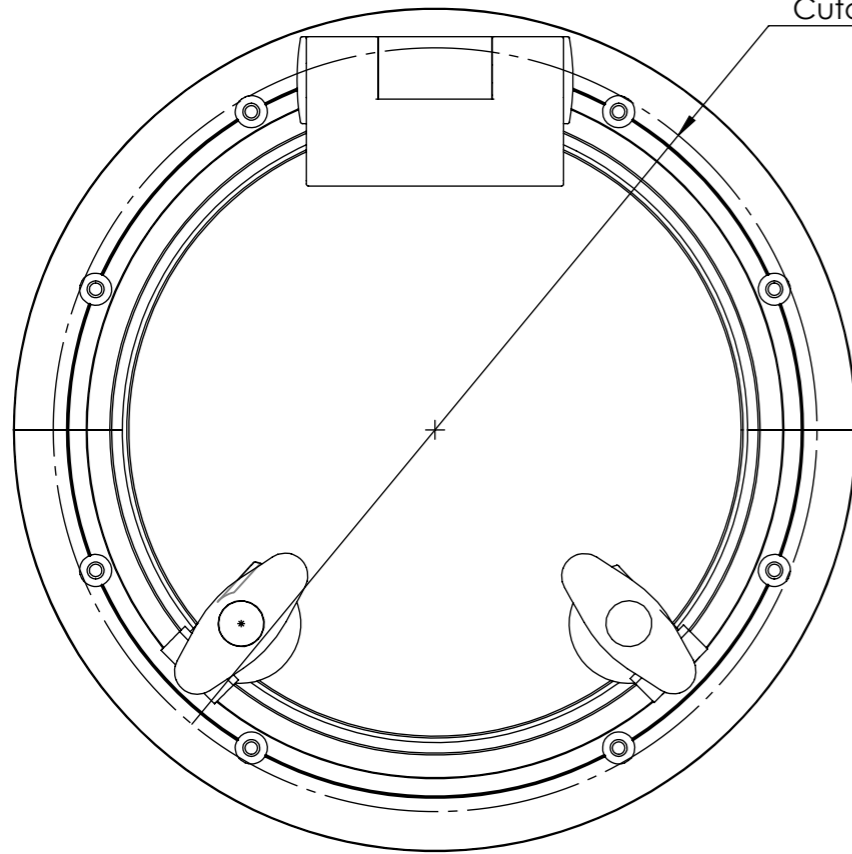

$\phi 202$

39

$\phi 223$

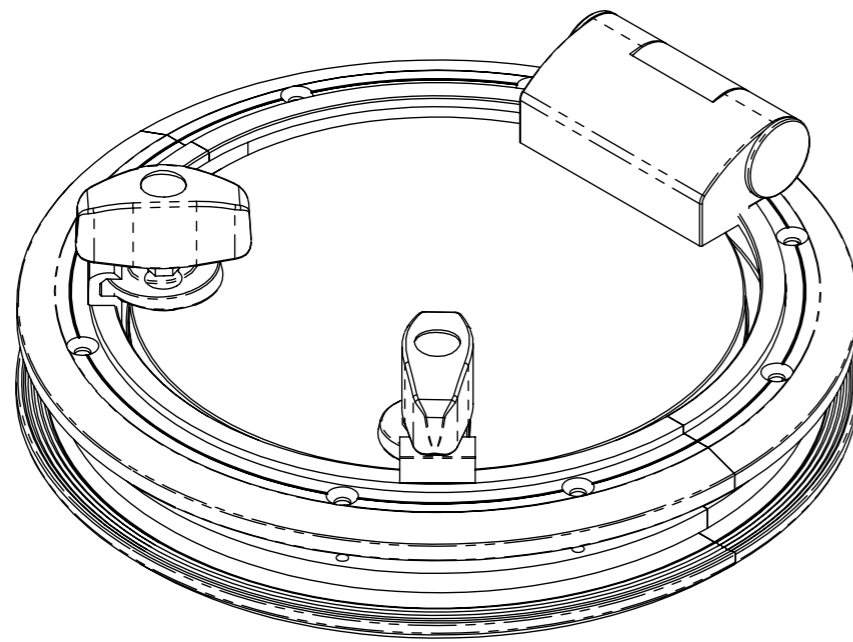
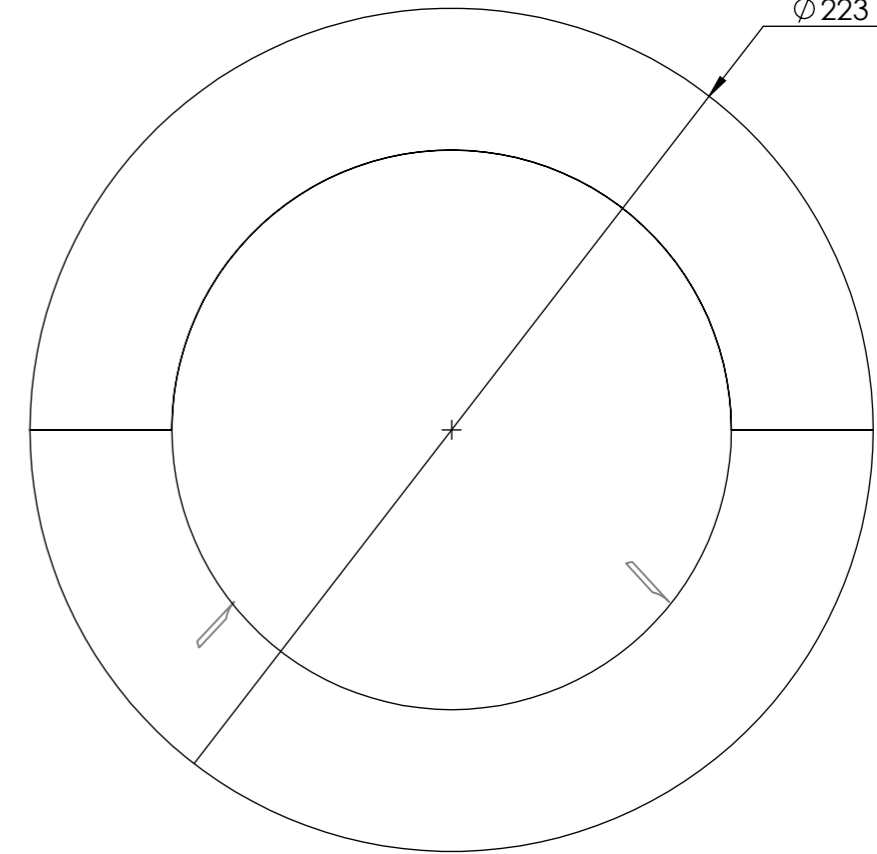

| Surface Finish | | | | | |
|--|----------------------------------|-----------|-------------------|-----------|----------|
| Ra Value μm | 0.012 / 0.025 / 0.05 / 0.1 / 0.2 | 0.4 / 0.8 | 1.6 / 3.2 / 6.3 | 12.5 / 25 | 50 / 100 |
| 120 to 315:±0.5 | 315 to 1000:±0.8 | | 1000 to 2000:±1.2 | | |
| 0 to 6 :±0.1 | 6 to 30 :±0.2 | | 30 to 120 :±0.3 | | |
| General Tolerances where not specified | | | | | |

| Date | Revision | Description | Initials |
|---------------------------------|-------------------|--|----------------------------|
| | | Description Main Frame Assembly $\phi 202$ | Dwg.no. FA.030.20180.01 |
| Material: | | Heat Treatment: | Weight: gms/Unit |
| Scale: N.T.S | Proj.: | Date: 14.08.2009 | |
| Drawn:Shankar.R | Checked:Chandru.D | Size: A3L | Dim. in: mm |
| Product group: CRAFTSMAN MARINE | | Sheet: 1 | of: 1 |



Craftsman
MARINE

Visersdijk beneden 70, 3319GVV Dordrecht, The Netherlands. Tel: +31 (0)88 0062600, Fax: +31 (0)88 0062601 - info@craftsmanmarine.com - www.craftsmanmarine.com
This drawing is the property of Craftsman Marine B.V., Dordrecht. Copyright reserved acc. law. It is not to be copied (in whole or in part) or otherwise disclosed without the written consent of Craftsman Marine B.V.